

**ILLUSTRATED PARTS MANUAL**

**FOR**

# **ROKON**

**UTILITY VEHICLES AND MOTO-TRACTORS**



**AMERICAN  
ENGINEERED AND MANUFACTURED**

Rokon International Inc  
50 Railroad Avenue  
Rochester, NH 03839

Tel: (603) 335-3200 Fax: (603) 335-4400

**JANUARY 1, 1982**

## PARTS LIST INSTRUCTIONS

I. Key to symbol

\* Not supplied as a single part

X Assembly

N. S. Not Shown

Accuracy when ordering parts prevents improper numbers and improper parts order completion. Specify the vehicle model, year, and color along with part number and part name.

## CONTENTS

Nomenclature	Page
Chains — All models .....	1
Clutch — MK. III & MK. IV Std. ....	2
Torque Converter Drive Pulley — All models .....	3
Torque Converter Driven Pulley — All models .....	4
Drive Line — All 2-wheel models .....	5
Drive Line — All 2-wheel models 1975 .....	6
Drive Line — 2-wheel drive Ranger & Scout .....	7
Engine Carburetor — All models .....	8 & 9
Engine Magneto — All models .....	10 & 11
Engine Power Head — All models .....	12 & 13
Engine Starter — All models .....	14
Engine Starter — Heavy Duty 5" .....	15
Dual Front Brake Caliper — All models .....	16
Rear Brake Caliper — All models .....	17
Engine Power Train (Belts) .....	18
Front Fork — MK. III Exp. ....	19
Front Fork MK. IV & MK. IV Auto. ....	20
Front Fork MK. III Auto. ....	21
Front Fork — RT 140 .....	22 & 23
Frame Components — MK. III Exp. ....	24 & 25
Frame Components — MK. IV Std. ....	26 & 27
Frame Components — MK. III Auto & MK. IV Auto .....	28 & 29
Frame Components — RT 140 .....	30 & 31
Frame Components — Ranger & Scout .....	32 & 33
Handlebar Assy. — MK. III, MK. IV Std., MK. IV Auto .....	34
Handlebar Assy. — MK. III Auto, Ranger & Scout .....	35
Handlebar Assy. — RT 140 .....	36
Jackshaft Components — RT 140 .....	37
Jackshaft Components — MK. III Auto & MK. IV Auto .....	38
Front Miter Box — All 2-wheel drive models .....	39
Front Miter Box — MK. III Exp., MK. IV Std., Ranger & Scout .....	40
Front Miter Box — MK. III Auto & MK. IV Auto .....	41
Rear Miter Box — MK. III Exp. & MK. IV Std. ....	42
Rear Miter Box — MK. III Auto & MK. IV Auto .....	43
Rear Miter Box — All 2-wheel drive models .....	44
Transmission-General .....	45
Three Speed Transmission .....	46 & 47
Transmission — MK. III & MK. IV Std. ....	48 & 49
Wheel Components — Drive — All models .....	50
Wheel Components — RT 140 Front .....	51
Front Cargo Rack .....	52



# CHAINS - ALL MODELS

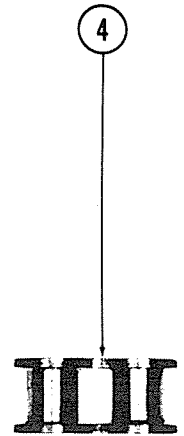
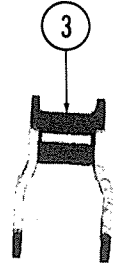
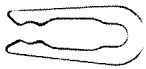
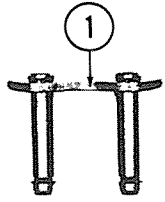

ITEM	PART NO.	NAME	DESCRIPTION	QTY.
1	100356	Connecting Link		1
2	see below	chain	#40	1
3	100355	off-set Link		1
4	100354	Full Link		1

### VEHICLE CHAIN PART NUMBER

MODEL	FRONT	REAR	PRIMARY
Mk-III Explorer	100316	100317	100318
Mk-III Automatic	100316	100317	100315
Mk-IV Std.	100319	100316	100318
Mk-IV Automatic	100319	100316	100315
RT-140	None	100316	100315
Rokon Ranger	101568	101570	None
Rokon Scout	100319	100316	None
Rokon Pioneer	None	100316	None

\*Not supplied as a single part

X-Assembly

N.S. — Not Shown

## CLUTCH - MK III EXP. & MK IV STD.

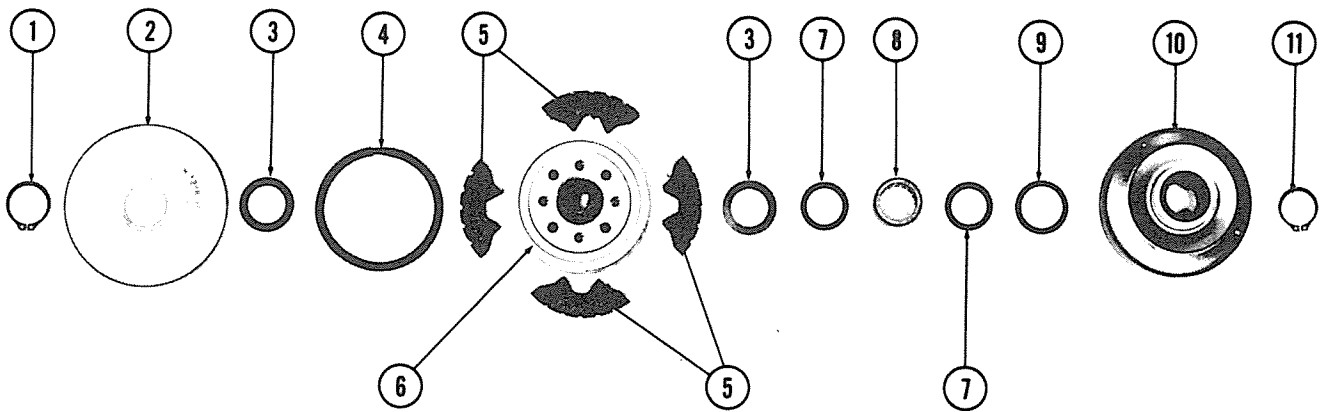

### CLUTCH — MK III EXP. & MK IV STD.

ITEM	PART NO.	NAME	DESCRIPTION	QTY.
1	100870	Snap Ring		1
2	100868	Cover		1
3	100875	Thrust Washer		2
4	100869	Clutch Spring		1
5	100866	Friction Shoe		4
6	*		Not Available	1
7	100874	Oil Seal		2
8	100867	Clutch Bearing		1
9	100876	Fiber Washer		1
10	*		Not Available	1
11	100871	Snap Ring		1
12	100050	Clutch Complete	Incl. Items 1-11	1

\* Not Supplied as a single part.

X - Assembly

N.S. - Not Shown

# TORQUE CONVERTER DRIVE PULLEY

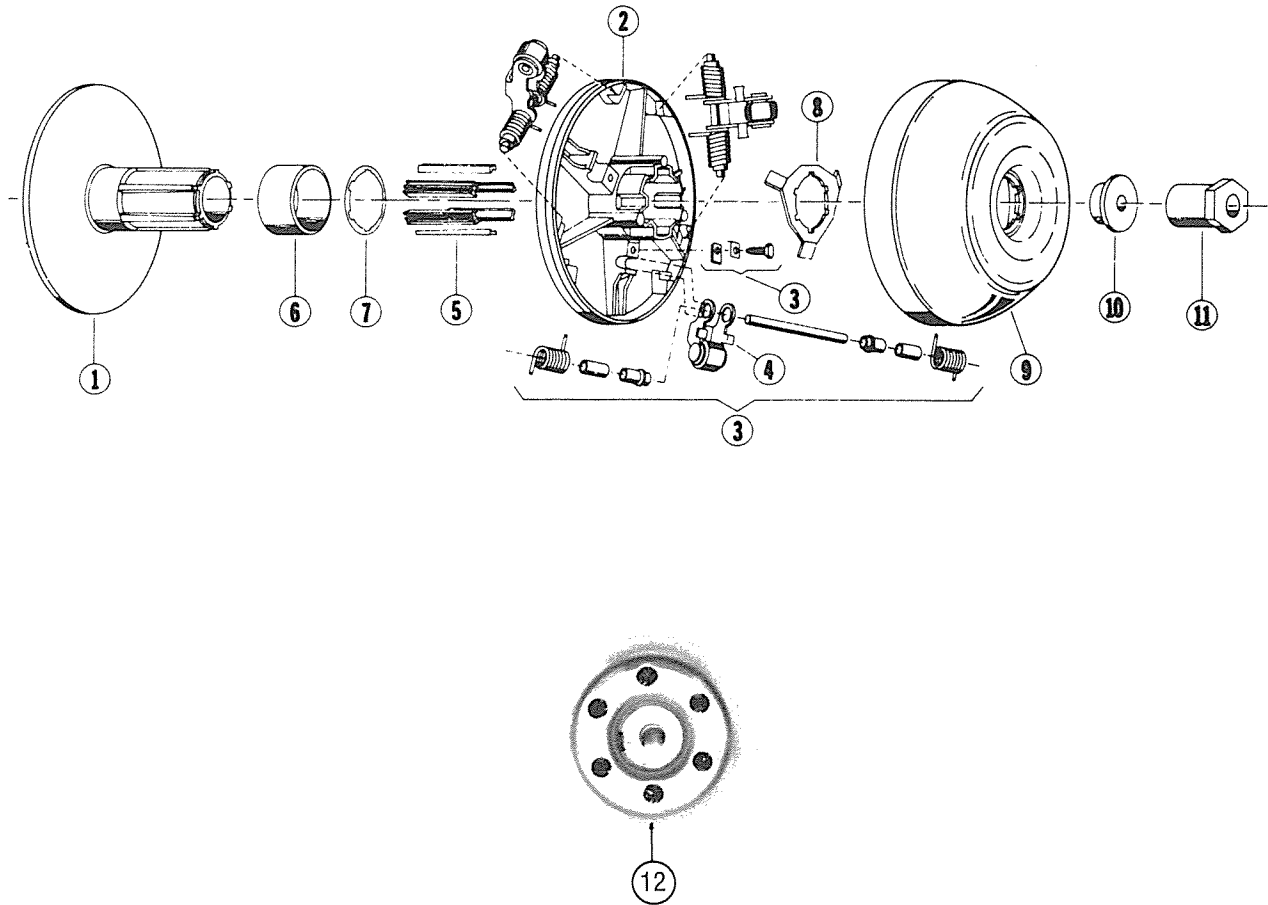

## TORQUE CONVERTER DRIVE PULLEY

ITEM	PART NO.	NAME	DESCRIPTION	QTY.
1	703209	Fixed Face & Hub Assy.		1
2	601319	Movable Face Assy.	Incl. Items 3 & 4	1
3	690144	Kit	Springs, Pins & Bushings	1
4	690146	Kit	Roller Arm Assy.	1
5	703128	Liner	Spline	6
6	703116	Bearing	Idler	1
7	703127	Washer	Idler Bearing	1
8	703129	Retractor		1
9	703151	Plate	Ramp	1
10	703211	Washer	Ramp Plate retaining	1
11	100493	Nut	Engine Shaft	1
12	100883	Drive Pulley	Front Incl. 1-10	1

\* Not Supplied as a single part

X - Assembly

N.S. - Not Shown

## TORQUE CONVERTER DRIVEN PULLEY

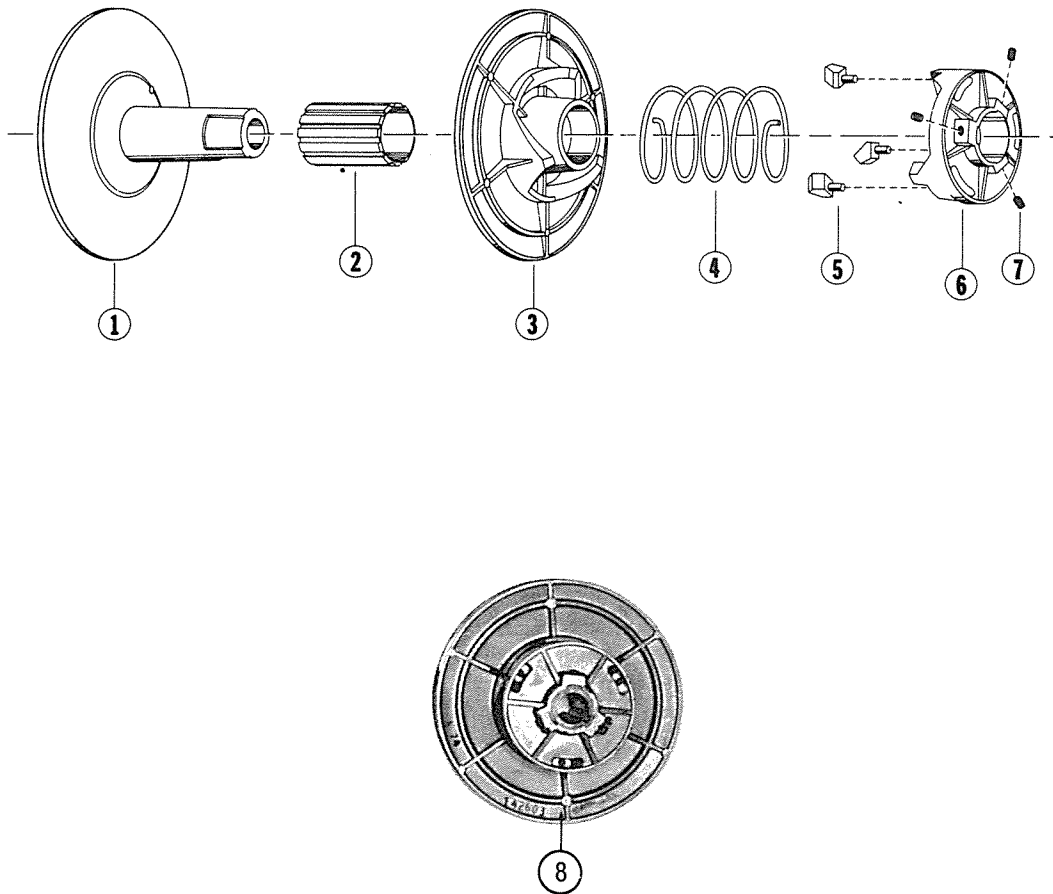

### TORQUE CONVERTER DRIVEN PULLEY

ITEM	PART NO.	NAME	DESCRIPTION	QTY.
1	601311	Hub — fixed face		1
2	703110	Bearing		1
3	703109	Movable Face		1
4	703111	Spring		1
5	703305	Button Shoe Ramp		3
6	601406	Torque Bracket	Incl. Items 5 & 7	1
7	901709	Set Screw		3
8	100884	Driven Pulley	Rear Incl. 1-7	1

\* Not Supplied as a single part

X - Assembly

N.S. - Not Shown